

Technical Data Sheet

BITUTHENE LM3000



Two component, elastomeric, liquid applied detailing compound for use with GCP waterproofing membranes.

Description

BITUTHENE LM3000 is a two component, elastomeric, cold applied, trowel grade material designed for a variety of uses with the GCP waterproofing systems. The VOC (Volatile Organic Compound) content is 10 g/L. Architectural and industrial maintenance regulations limit the VOC content in products classified as architectural coatings. Refer to Technical Letters for the most current list of allowable limits.

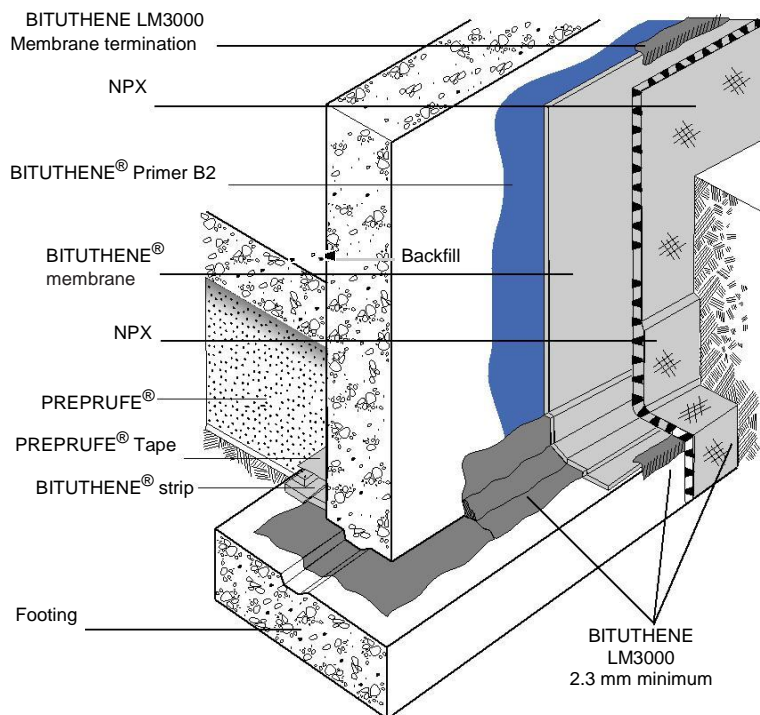

Drawings are for illustration purposes only.
Please refer to www.allnexconstruction.com for specific application details.

Product Advantages

- Liquid applied
- Waterproof
- Tough, rubber-like
- Chemically cured
- Cold applied
- System Compatible

Use

BITUTHENE LM3000 is ideally suited for the following uses:

- Fillet material at inside corners
- Reinforcement material at inside corners
- Flashing material around drains, protrusions, curbs and parapets
- Sealing material at terminations
- Repair material for defects on concrete surfaces
- Flashing material at corners

The two parts of BITUTHENE LM3000 are mixed on site and troweled on to provide a simple and quick waterproofing detailing aid in conjunction with BITUTHENE and PREPRUFE systems.

Compatibility

BITUTHENE LM3000 is completely compatible with BITUTHENE, PREPRUFE and with existing asphalt or coal tar-based waterproofing materials. It is also compatible with cured silicone and polyurethane sealants. It is not compatible with creosote, pentachlorophenol, linseed oil or polysulfide-based sealants.

Supply

BITUTHENE LM3000 PROPERTY	VALUE
Unit size	5.7 L
Net weight per unit	5.6 kg
Units per pallet	100

Physical Properties

PROPERTY	TYPICAL VALUE	TEST METHOD
Part A Colour	Black	
Part B Colour	Clear	
Mixture of Parts A and B Colour	Black	
Solids content	100%	ASTM D1644
Elongation	250% minimum	ASTM D412
Peel strength	5 lbs/in. (880 N/m) minimum	ASTM D903
Flexibility, 180° bend over 1 in. (25 mm) mandrel at -25°F (-32°C)	Unaffected	ASTM D1970

Application Procedures

Safety, Storage and Handling Information

BITUTHENE products must be handled properly. Vapours from solvent based primers and mastic are harmful and flammable. For these products, the best available information on safe handling, storage, personal protection, health and environmental considerations has been gathered. Safety Data Sheets (SDS) are available on the web site and users should acquaint themselves with this information. Carefully read detailed precaution statements on product labels and the SDS before use.

Surface Preparation

All surfaces must be dry and free from dirt, grease, oil, dust or other contaminants. BITUTHENE LM3000 may be applied at temperatures of -4°C or above. Store in a dry.

Mixing

Add the entire contents of the Part B container to Part A and mix for 3 to 5 minutes until uniform. Part A is black and Part B is clear. Take care to scrape material from the side and bottom of the containers to ensure thorough mixing. A low speed (150 rpm) mechanical mixer with flat paddle blades is required.

Do not apply any material if streaks can be seen due to insufficient mixing. Once mixed, BITUTHENE LM3000 must be applied by trowel within 1.5 hours. More time is available at lower temperatures.

At high temperatures, thickening and curing will be faster. Material that has thickened must be discarded. The material will cure to a very flexible rubber-like material.

BITUTHENE LM3000 must be applied at a minimum thickness of 2.3 mm unless otherwise noted on details. In fillet applications, the face of the fillet should be a minimum of 20 mm. In corner flashing application details, it should extend 150 mm in each direction from the corner. BITUTHENE LM3000 will adhere to primed or unprimed concrete.

BITUTHENE LM3000 should be allowed to cure at least 24 hours before flood testing.

Coverage

As a fillet material, 3.8 L will cover approximately 30 m. As a flashing material, 3.8 L will cover approximately 1.6 m. As a fillet and reinforcement, 3.8 L will cover approximately 4.3 m.

Cleaning

Clean tools and equipment with mineral spirits before BITUTHENE LM3000 has cured. Mineral spirits is a combustible liquid and should be used only in accordance with the manufacturer's safety recommendations. Do not use solvents to clean hands or skin.

Date: July 2018
Replaces August 2017



Allnex Construction Products, a Division of Allnex New Zealand Ltd

Auckland - 14 Industry Road Penrose phone: 095836544. Hamilton - 18 Somerset Street Frankton phone: 07-847-8658
Wellington - 19A Jamaica Drive Grenada North phone: 04-240-0305. Christchurch - 112 Carlyle Street Sydenham phone: 03-366-6802
Customer Service: 0508-882-288 cs.constructionnz@allnex.com
www.allnexconstruction.com

The allnex logo, with "allnex" in a bold, lowercase sans-serif font. Above the letters "i" and "l" are horizontal bars in red and green respectively.

DISCLAIMER: This information appearing in this Document (**Details**) concerning the product which is the subject of the Document (**Product**) is either based on present technical knowledge and tests done by allnex or tests done by, and data supplied from third parties including you, the customer. Since the actual use by you and by others of the Product is beyond the control of allnex, no warranty or representation, express or implied is made by allnex regarding the suitability for such use, nor does allnex accept any liability arising out of the use by you of other products or materials, whether third party or not, that may be referred to in this Document. allnex recommends that you carry out your own tests as to the suitability of the Product for your purpose, regarding which you accept full responsibility. In addition, if any of the Details appearing in the Document are based upon tests done by, and/or data supplied by any third party, allnex provides no warranties or representations in connection with those Details and you, the customer waives any right you may have against allnex in connection with the accuracy, completeness or otherwise of the Details. The information in this Document is not to be construed as absolutely complete or accurate since additional information may be necessary or desirable when particular or exceptional conditions or circumstances exist or because of applicable laws or government regulations affecting use of the Product. allnex does not provide any warranty or representation to you that the Product does not infringe the intellectual property rights of any third party. All orders accepted shall be subject to the standard conditions of sale of allnex which are on the back of our invoice. In accepting the Product you, the customer acknowledge and agree: **a.)** The Product is or may be of a hazardous nature and that you, the customer, are responsible for the disposal of the container housing the Product in accordance with the requirements and regulations of the relevant supervising government. **b.)** The Product has a limited shelf life and must be stored strictly in accordance with the guidelines and specifications related to it. **c.)** Where the Details relate to Product tested by allnex, those Details are indicative only, regarding which there may be batch to batch variation. **d.)** allnex gives no warranty or representation as to the applicability for the particular use by you, the customer, of the Product and you the customer shall be responsible for ensuring that the Product is fit for your intended use. **e.)** allnex's liability for breach of any term, condition, guarantee or warranty (express or implied and concerning the information in this Document or the Product more generally) including any liability for direct or indirect consequential loss (including indirect loss of profits), is limited to the maximum extent permitted by law and, at allnex's election, to either replacing or repairing the goods or paying the cost of replacing or repairing the goods, or in the case of services, supplying the services again.